

Spritzgiessautomaten

1.1 Technical data



Machine model 50 M, 50 A, 50 T2
International size 500-183

Clamping unit

Clamping force	kN	518			
Mould closing force	kN	18,3			
Mould opening force	kN	40,6			
Mould opening stroke, max.	mm	350			
Maximum plate distance	mm	600			
Minimum plate distance	mm	250			
Clear width between tie bars	mm	335 x 305 (h x v)			
Diameter tie bar	mm	55			
Ejector force pushing / pulling	kN	18,1 / 12,0	(18,1 / 12,0)	(38,1 / 26,7)	
Ejector stroke	mm	80	(130)	(150)	
Size of platens	mm	500 x 500			

Injection unit

Screw diameter	mm	28	32	38	42
Screw-LD ratio	—	20,5	18	15	13,6
Flight depth ratio	—	2,25	2,00	2,26	2,24
Spec. injection pressure	bar	2470	1891	1341	1098
Theor. stroke volume	ccm	73,9	96,5	136,1	166,3
Injection weight with polystyrene	g	66	86	121	148
Plasticising rate	g/s	9,72	13,33	17,77	20
Injection rate	g/s	58,22	76,91	108,17	129,26
Injection force	kN	152			
Screw stroke	mm	120			
Screw torque	Nm	415 (1)	330 (2)		
Screw speed	U/min	325 (1)	410 (2)		
Screw retraction force	kN	26,4			
Nozzle pressure force	kN	66			
Nozzle stroke	mm	210			
Heating capacity (3)	W	3 x 1950 + 450 + 200			
Hopper capacity	L	58			

General

Number of drycycles (Euromap)	1/min	38
Installed driving power	kW	11
Installed total power (3)	kW	17,5
Hydraulic system pressure	bar	160
Oil tank capacity	L	215

Dimensions

Length of machine	mm	3395
Width of machine	mm	1000
Height of machine	mm	2000
Floor area	m ²	3,4
Total weight net (without oil)	kg	2270
Total weight gross (without oil)	kg	2510
Mould cooling connection	—	R 1/2"
Oil cooling connection	—	R 3/4"
Resounding power level	dB (A)	82,6 (4)

- (1) 415 Nm, 325 rpm – 204 ccm Motor
 (2) 330 Nm, 410 rpm – 162 ccm Motor
 (3) Standard barrel
 (4) DIN 45635

Schließseite

Closing side (Moving platen)
Cote fermeture
Lado de cierre

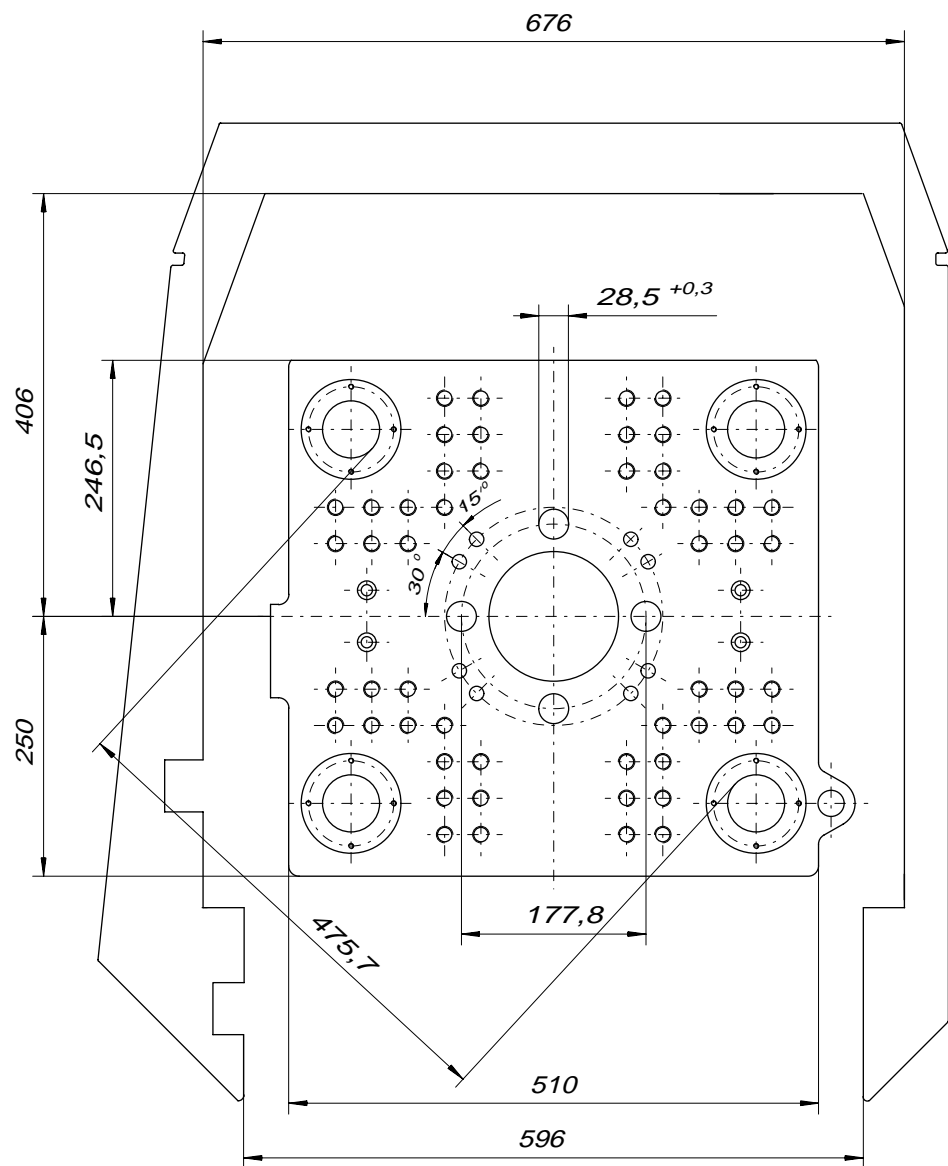

Spritzseite

Injection side (Fixed platen)
Cote injection
Lado de inyeccion

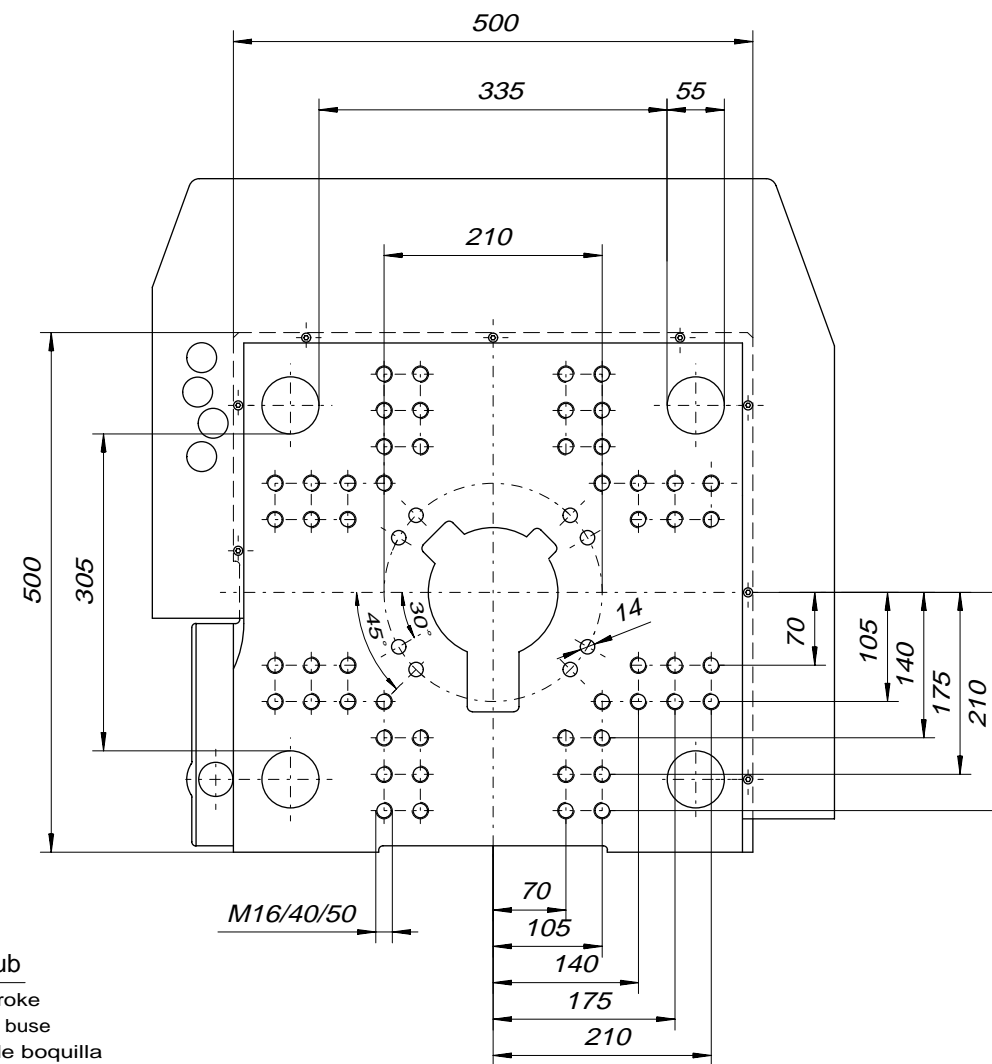

Verstellbereich

adjustable range
distance a ajustar
distancia regulable

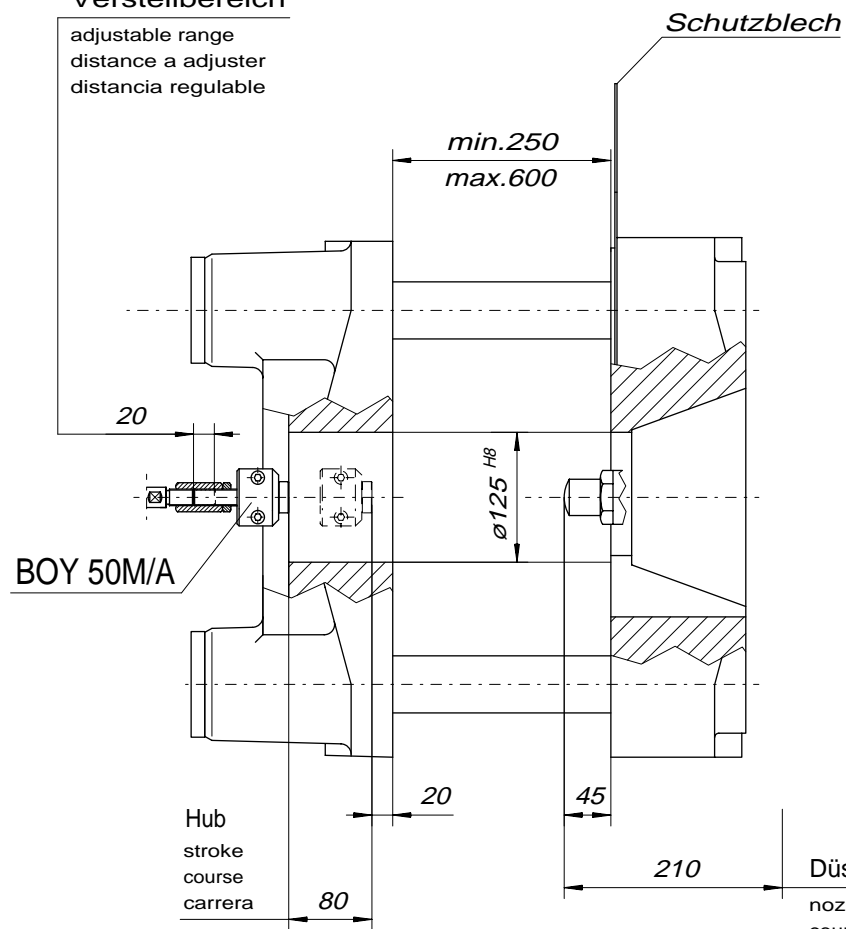

Düsenhub
nozzle stroke
course de buse
carrera de boquilla

Befestigungsbohrungen für Handlinggerät

fastening of handling device
appareils périphériques
aparatos perifericos

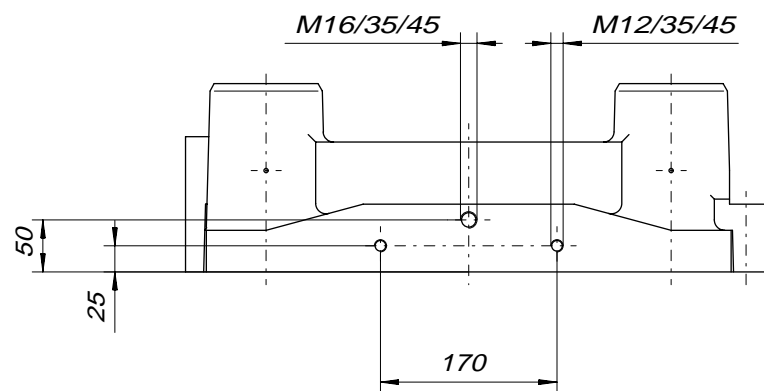

BOY 50T2

Hub
stroke
course
carrera

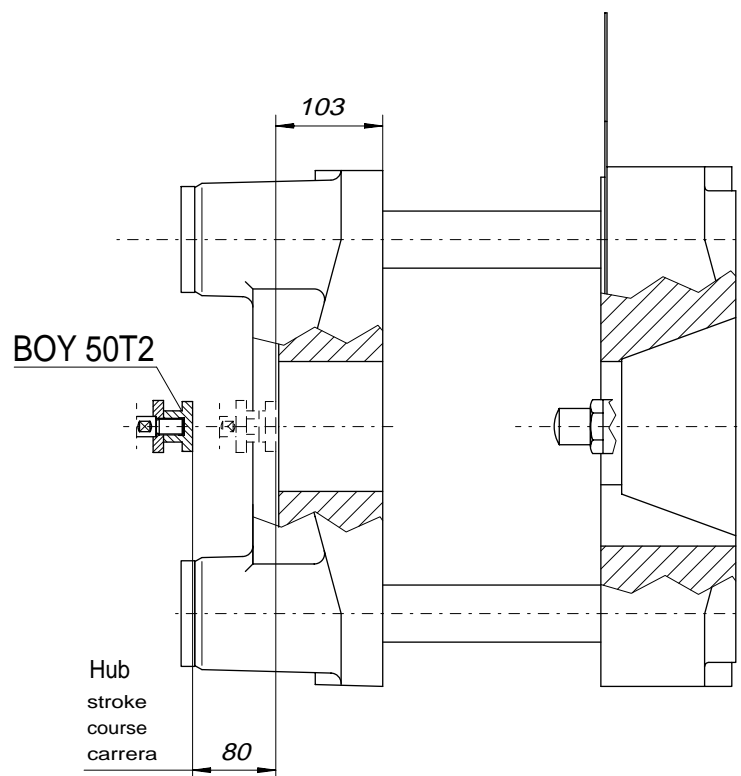

Befestigungsbohrungen für Handlinggerät

fastening of handling device
appareils périphériques
aparatos perifericos

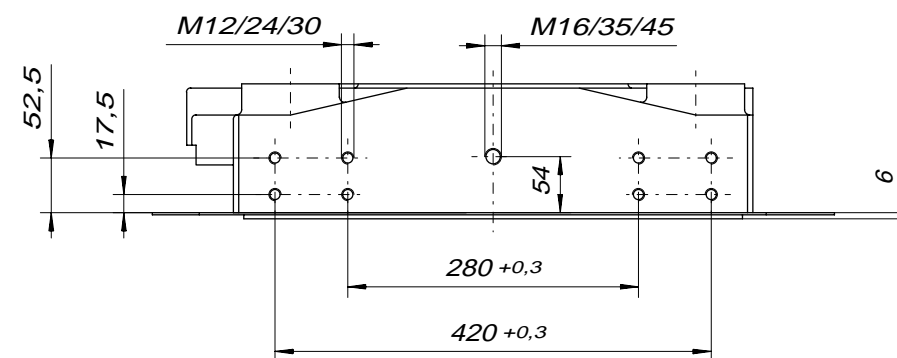

BOY 50M/A, 50T2

160591-0 c